

# ML23HS8L4360-E

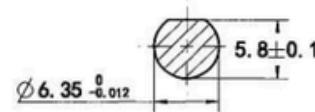

### Wiring Diagram

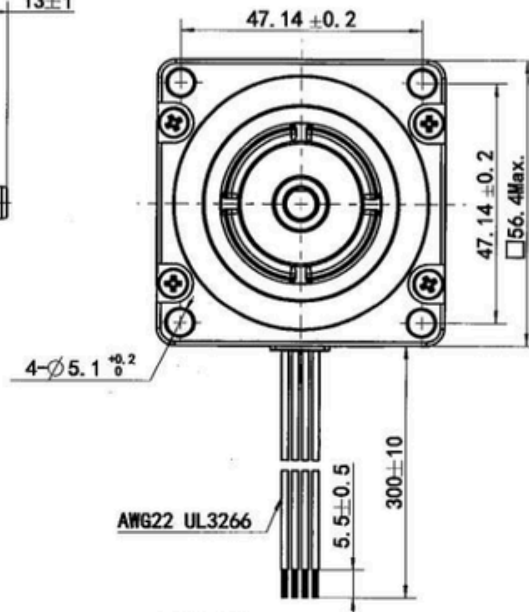
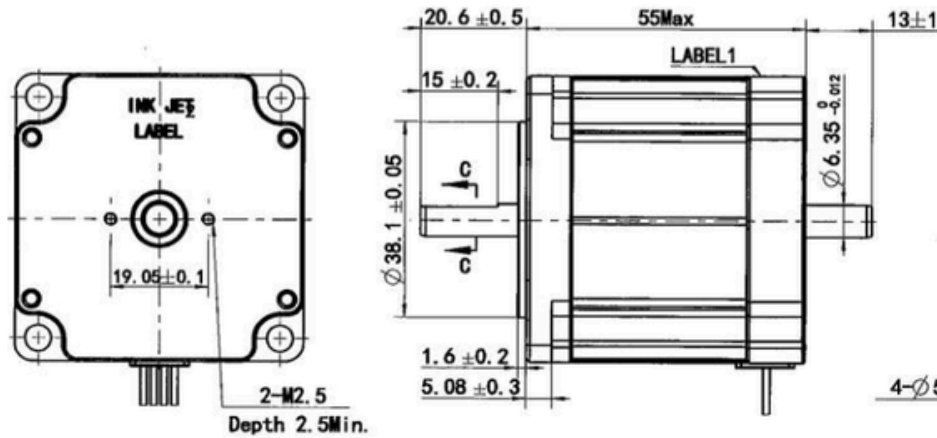
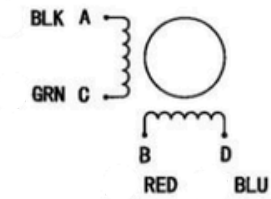

### Exciting Sequence vs. Direction of Rotation

STEP	A	B	C	D	
1	+	+	-	-	CCW
2	-	+	+	-	
3	-	-	+	+	
4	+	-	-	+	CW

Clockwise view from mounting side

### 1 Label1 Detail

**MOONS' STEPPING MOTOR**  
 Insulation: Class B, 60VDC Max.  
 3.6Amps Holding: 1.5Ns  
 3000RPM Max. **UL** US  
 UL FILE No. E465363 XXX

Factory ID

### 2 Label2 Detail

TYPE ML23HS8L4360-E  
 XXXXXXXX YY/MM/DD  
 Work Order Date Format

1. Number of Phase	2
2. Step Angle	1.8°
3. Rated Voltage	2.27 V DC
4. Rated Current	3.6 Amp
5. Holding Torque	1.5 Nm Typ. (Two phase on/rated current)
6. Phase Resistance	0.63 ± 0.1ohm (20°C)
7. Phase Inductance	2.6 mH ± 20% (1kHz 1V rms)
8. Rotor Inertia	215 gcm <sup>2</sup>
9. Motor Weight	0.6 kg
10. Insulation Class	B (130°C)

Unit: mm  
 FIRST ANGLE METHOD  
 Tolerance for linear and angular dimensions without individual tolerance indications  
 GB/T 1804-m eqv ISO 2768-1 : m  
 Geometrical tolerance for features without individual tolerance indications  
 GB/T 1184-K eqv ISO 2768-2 : K

Approve	Standardize	Process Review	Check	Design

# PIVEXIN TECHNOLOGY

REV.	REVISION RECORD	DATE
A1	ECR:23-317:There is one position. Δ	2023.03.31
A0	Original revision	2017.09.16